

香港客戶服務中心
香港新界葵涌勝耀街8號信興中心19字樓
電話: (852) 2406 5439 傳真: (852) 2408 1389

Hong Kong Customer Service Centres:

19/F, Shun Hing Centre, 8 Shing Yiu Street, Kwai Chung, N.T.
Tel: (852) 2406 5439 Fax: (852) 2408 1389

澳門客戶服務中心

澳門雅廉訪大馬路56號A東方花園地舖
電話: (853) 2852 6286 傳真: (853) 2852 7354

Macau Customer Service Centres:

Avenida do Ouvidor Arriaga, No.56A, R/C, Edf. Tong Fong Garden, Macau

Tel: (853) 2852 6286 Fax: (853) 2852 7354

有關最新之客戶服務中心資訊, 請參閱信興服務中心網址:
www.shunhing-service.com 或致電維修服務熱線查詢。

For the latest information of customer service centres, please
visit www.shunhing-service.com or call us at our hotline.

Rasonic 樂信牌

信興電工工程有限公司

SHUN HING ELECTRIC WORKS AND ENGINEERING CO., LTD.

辦公室: 香港九龍尖沙咀東部麼地道67 號半島中心9樓909-912室

電話: (852) 28612767 圖文傳真: (852) 28656706

網址: <http://www.shew.com.hk> 電郵: shew@shunhinggroup.com

Office: Room 909-912, 9/F, Peninsula Centre, 67 Mody Road, Tsim Sha Tsui East, Kln, H.K.

Tel: (852) 28612767 Fax: (852) 28656706

Web Site: <http://www.shew.com.hk> E-mail: shew@shunhinggroup.com

保養及維修 Maintenance Repair Service:

信興電器服務中心有限公司

SHUN HING ELECTRIC SERVICE CENTRE LTD.

香港新界葵涌勝耀街8號信興中心18字樓

電話: 2406 5666 圖文傳真: 2408 0316

網址: <http://www.shunhing-service.com>

Office: 18th Floor, Shun Hing Centre, 8 Shing Yiu Street, Kwai Chung, N.T., H.K.

Tel: (852) 2406 5666 Fax: (852) 2408 0316

Web Site: <http://www.shunhing-service.com>



Rasonic
樂信牌

全自動洗衣機

Fully Automatic Washing Machine

RW-H603PC

RW-H703PC

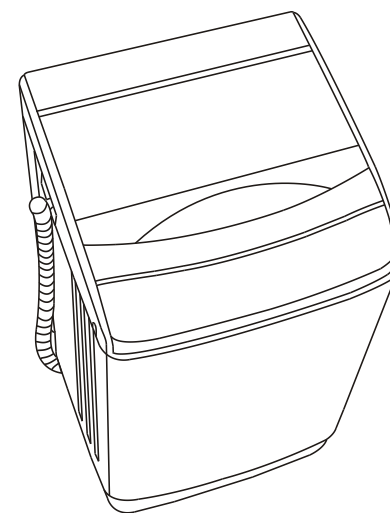

目錄 Content

產品特點	1
注意事項	2-3
各部件名稱	4
控制面板說明	5
安裝及洗衣前準備	6-8
洗滌操作	9-10
洗衣機保養	11
問題檢測	12-13
故障信息表	14
技術參考	15
Product features	16
Precautions	17
Name of parts	18
Control panel	19
Installation & Preparations before washing	20-22
Washing operation	22-23
Maintenance	24
Trouble shooting	25-26
Error list	27
Specification	28

For household use only
僅適用於家庭使用

使用說明書

OPERATION MANUAL

- 使用本產品前, 請仔細閱讀本使用說明書, 並妥善保存本說明書以備用戶日後查詢。
- Please carefully read this operation manual before using the product and please well keep this operation manual for your future reference.

Specification

Model No.	RW-H603PC	RW-H703PC
Maximum washing capacity	6.0kg	7.0kg
Maximum spinning capacity	6.0kg	7.0kg
Spin Speed	700rpm	700rpm
Rated power (Wash)	380W	420W
Rated power (Spin)	380W	420W
Dimensions (WxDxH)	530x530x915mm	550x550x935mm
Net weight	29kg	31kg
Drainage design	High/Low drainage	High/Low drainage

Remarks:

- The images shown in this manual are for illustrative purposes only. Some illustrations are presented as conceptual images and may be different from the actual products.
- The content in this Operation Manual has been checked. Our company reserves the right on final interpretation to any printing errors or misunderstanding on the content.
- If there are technical improvements on the appliance, the operation manual will be updated in new version without prior notice. The product appearance and specifications are subject to the manufacturer information.

產品特點

- 自動斷電
洗衣程序結束後，洗衣機會自動斷電，有效防止意外發生。
- 24小時預約洗衣
- 多瀑布立體水流
多瀑布立體循環水流，有效提高大件衣物的潔淨度。
- 10段水位
特有10段水位選擇，可根據衣物質料和重量，隨意選擇最合適水位，省水又省電。
- 風乾功能
脫水後，借助內桶高速旋轉產生的自然風，疏鬆衣物，節省衣物晾曬時間。
- 童鎖功能
能鎖定已設定的程序，防止洗衣時兒童誤按改變程序。
- 快思邏輯
根據衣物重量自動選擇水位。

Rasonic
樂信牌

注意事項

<ul style="list-style-type: none"> 請確定洗衣機是否平穩 	<ul style="list-style-type: none"> 洗衣機應放置在堅硬水平的地面上 
<ul style="list-style-type: none"> 洗衣時請勿把手放進洗衣桶內及勿讓小孩靠近洗衣機。 	<ul style="list-style-type: none"> 請將衣物均勻地放入洗衣機內，衣物放置不均勻會產生噪音或振動。 
<ul style="list-style-type: none"> 請勿洗滌帶有汽油、煤油、酒精或溶劑類的衣物（會有引起火災的危險）。 	<ul style="list-style-type: none"> 請勿使用熱水洗衣（水溫不應超過50度）否則洗衣機塑膠零件會損壞或變形；衣物也會變形、縮小或褪色。 
<ul style="list-style-type: none"> 洗衣前請將口袋內的東西全部拿出，尤其是釘子或針之類的東西會損壞機器及衣物。 	<ul style="list-style-type: none"> 不可用尖銳的物品觸碰控制面板，以免損壞或產生故障。 

Rasonic
樂信牌

Error list

Trouble removal

Display Message	Indication	Reason
E1	trouble in water inlet	No water, water-inlet overtime, clogging water inlet valve.
E2	Water level trouble	Water level lower than lowest water level or sensor occurring problem
E3	Top cover opened	During spinning, the top cover is not closed; before appointed start up ,the top cover is not closed.
E4	Imbalance trouble	Imbalance occurs during spinning
E5	Drain trouble	Drain valve is clogged, trouble occurs in drain motor and drain overtime occurs.
E8	trouble in water -level sensor	Water level is higher than maximum water capacity
CL	Child lock alarm	Top cover is opened while child lock mode

Note: If trouble occurs, open/close the top cover or press the start /pause key so as to release trouble information. After the trouble information is released, the trouble may occur again in the coming procedure if the trouble is not removed.

- Do not over loads, under loads or unbalance loads in order to prevent the washing machine vibrating, this may cause danger and damage to washing machine.
- Do not leave an operating washing machine unattended.
- Valve off the water and unplug the washing machine after using
- This appliance is not intended for use by persons (including children) with reduced physical, sensory or mental capabilities, or lack of experience and knowledge, unless they have been given supervision or instruction concerning use of the appliance by a person responsible for their safety.
- Children should be supervised to ensure that they do not play with the appliance.
- Use an individual socket for the washer. Do not use a socket sharing the power source with other high power consumption machine.

Appendix Program Reference

Course	Soak	Wash	Rinse	Spin	Required time	Water level
STANDARD		18 min	Full tub rinse 2 times	6 min	Approx. 53 min	22~55L
QUICK		6 min	Full tub rinse 1 times	6 min	Approx. 27 min	22~55L
BLANKET	15 min	20 min	Full tub rinse 2 times	7 min	Approx 70 min	22~55L
GENTLE		10 min	Full tub rinse 2 times	5 min	Approx 41 min	22~55L
STRONG		20 min	Full tub rinse 3 times	8 min	Approx 71 min	22~55L
MINI WASH		6 min	Full tub rinse 1 times	3 min	Approx 17 min	22~55L
CHILD WASH	5 min	20 min	Full tub rinse 2 times	7 min	Approx 72 min	20~55L
CLEAN TUB		10 min		7 min	Approx 23 min	50L
AIR-DRY				45 min	Approx 45 min	22~55L
WATER RECYCLING		15 min	Full tub rinse 2 times	8 min	Approx 50 min	22~55L

Above operation time is just for reference; actual working period will be affected by below issues:

Water level.

Water pressure, drainage conditions and the clothing materials.

Trouble shooting

Trouble removal

- No power supply
- Check if the [power ON/OFF] key is pressed.
 - Check if the power plug is plugged.
 - Check if it is a power cut.

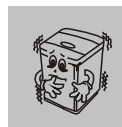

- Noise and vibration occur during Spinning operation
- Check if the clothes lean towards one side.
 - Check if the washing machine is stably positioned.
 - Check if the sound insulation board is properly installed.
 - Remove the foreign materials around the washing machine.

- Operation is impossible
- Check if the [start/pause] key is pressed.
 - Check if the water amount is appropriate.
 - Check if the water tap is opened

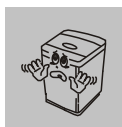

- Water leakage occurs at connecting point of water inlet hose.
- Check if the connecting point with water tap is loosened.
 - Check if the rubber ring of water inlet hose is properly fixed.
 - Check if water leak occurs in the water tap.

The following phenomena do not indicate a trouble

Phenomena	Reason
The machine is abruptly switched to rinsing procedure from dewatering procedure	<ul style="list-style-type: none"> * If the clothes are unevenly placed, the machine will automatically be switched to rinsing procedure so as to adjust the uneven status of clothes, and then it will restore to carry out dewatering operation. * If the aforesaid modification is repeated for thrice, and the phenomenon cannot be corrected yet, the buzzer will gives out a sound; Just open the top cover to place the clothes evenly.
At the beginning of dewatering, the dewatering barrel rotates on off.	<ul style="list-style-type: none"> * At the beginning of dewatering operation, dewatering barrel will be gradually started up, and then it is accelerated. This is the intermittent dewatering procedure so as to avoid residual of soap foam.
Replenishing water when washing	<ul style="list-style-type: none"> * Microcomputer can frequently detect the water level during washing /rinsing procedure. When water level is lower, the machine will automatically replenish water.
Slight, consecutive and repeated rotation of wave wheel before drain operation	<ul style="list-style-type: none"> * To prevent clothes from leaning toward one side during dewatering operation, which leads to imbalance (if clothes lean toward one side during dewatering operation, abnormal noises may occur) .
Slightly heat on the control panel	<ul style="list-style-type: none"> * It is normal for slightly heat on the control panel if the power plug plugged in socket for a long time. Please unplug the power when the product is not in use.

注意事項

電源線的安全

- 拔下插頭時，一定要握住插頭，切勿拉扯電源線。
- 請勿將重物置於電源線上，勿讓電源線受到擠壓。
- 如果電源線損壞，為避免危險，請停止使用，並聯絡信興電器服務中心有限公司。
- 請勿使用破損的插頭或插座，以免觸電或發生火災。
- 請勿用濕的手插拔電源插頭，以免觸電。
- 在有氣體泄漏的地方，切勿插拔電源插頭。
- 當不使用洗衣機時，請將電源線插頭從插座拔下。

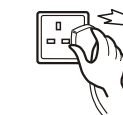
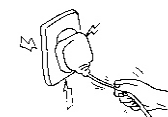

接駁電源及地線

- 電源插座必須有可靠的接地線。
- 電源插座必須安裝保險絲。

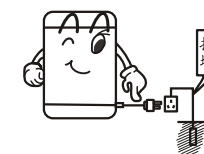

警告

- 絕對不可將地線接到煤氣管、自來水管、電話線或避雷針的接地線上。
- 如果電源線及其插頭有破爛，必須立即停止使用，以防漏電及火災。
- 如果電源線損壞，為避免危險，請聯絡信興電器服務中心有限公司更換，電話：24065666。

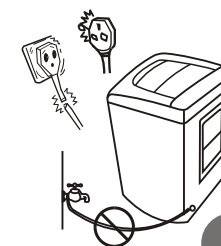

Rasonic
樂信牌

各部件名稱

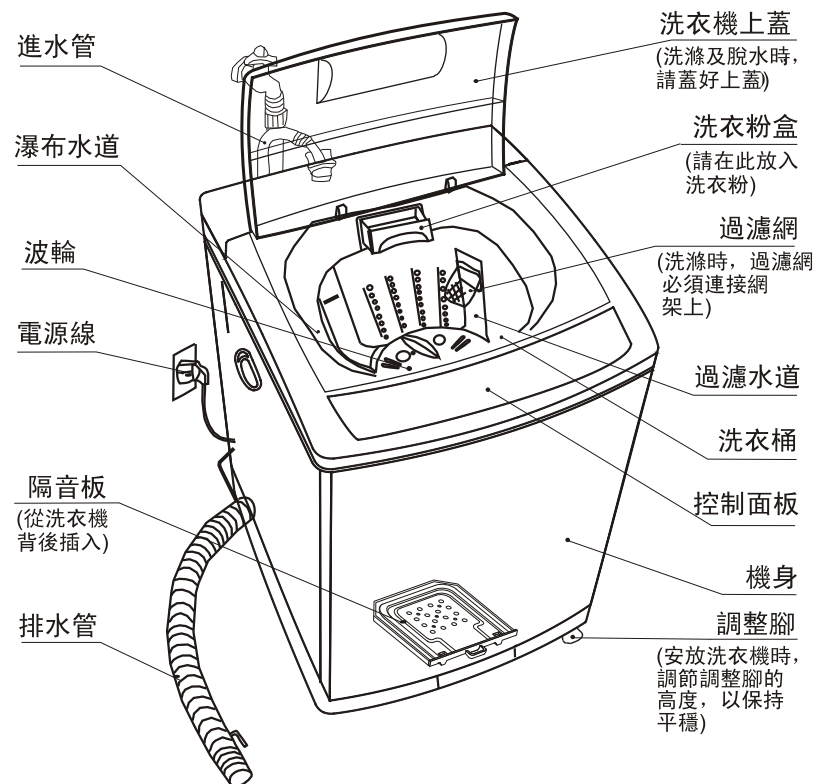

附 件

隔 音 板	排 水 管 / 彈 簧 夾	進 水 管

Rasonic
樂信牌

Trouble shooting

Key points for trouble locating



- Cannot run
- Is the water tap opened?
 - Is the plug plugged into the supply socket properly?
 - Is power supply turned on?
 - Is the water level enough?

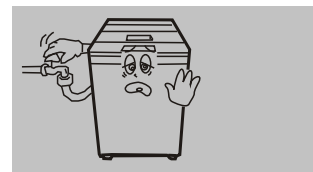

- Water inlet problem
- Is the water tap opened?
 - Is the water supply ceased?
 - Is the water inlet hose of connecting pipe clogged?

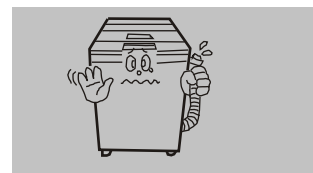

- Cannot drain
- Is the drain pipe let down?
 - Is the drain pipe clogged?
- (Buzzer will prompt if the machine cannot drain for 5 minutes)

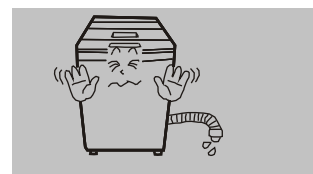

- Cannot spin
- Is the clothes evenly put inside the washing drum?
 - Is the washing machine positioned stably and horizontally?
 - Is the top cover of washing machine closed?



- Cannot open/close
- Checking the power supply.
 - Contact
Shun Hing Electric Service Centre Ltd.
Tel: 24065666



- Water leakage
- Contact
Shun Hing Electric Service Centre Ltd.
Tel: 24065666

Maintenance

- When washing operation has completed, unplug the power plug.

How to clean filter net

Firstly, take out the filter net upward, turn over the filter net and remove the dirt inside it. Rinse it by fresh water, restore it to its original state, and then reassemble it into the washing machine.



How to clean filter screen of water inlet valve

It is required to periodically clean filter screen of water inlet valve; draw the filter screen out of water inlet valve, use brush to remove dirt on the filter screen. Rinse it with fresh water, and place it into the water inlet valve.

Note:

- Remove the water inlet hose according to the following procedures.

- Close the water tap.
- Turn on "power".
- Press the "start/pause" key.
- Loose and remove adapter of water inlet hose in washing machine.
- Press the "power" key to turn off the power.



- Dirt in filter screen of water inlet valve may result in failure of water inlet or less water inflow etc.
- After the filter is cleaned, it must be reassembled into the water inlet valve.

External cleaning

- Do not directly squirt water to the washing machine for cleaning.
- Use dry soft cloth to wipe the washing machine.

控制面板說明

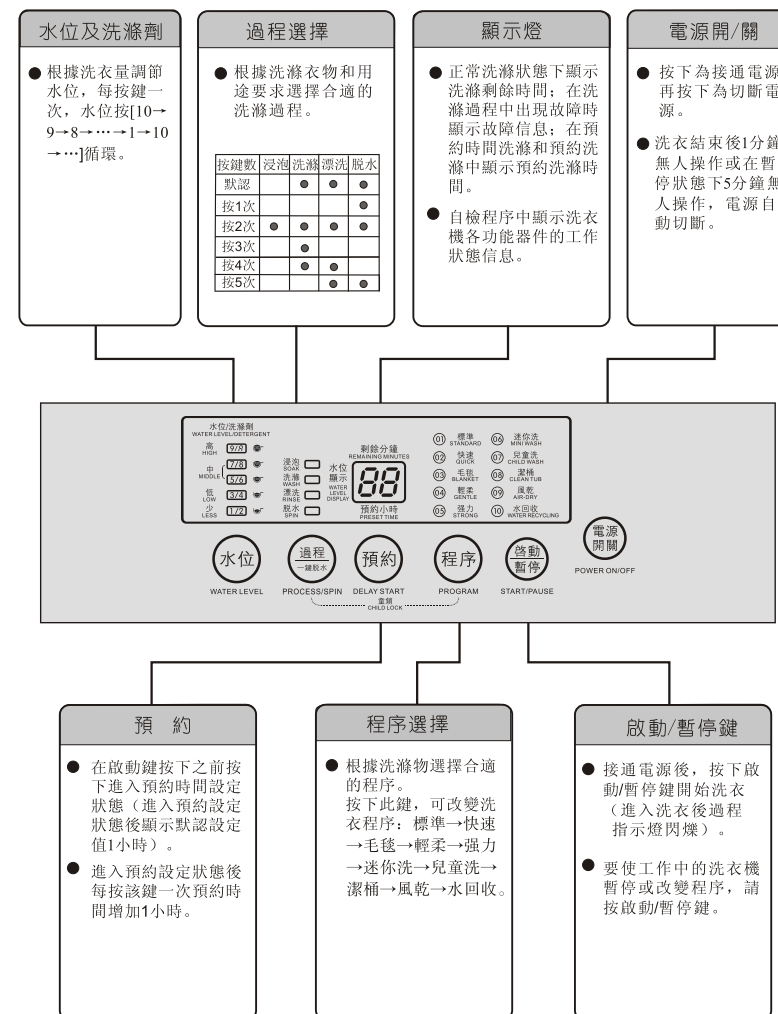

童鎖：在按下[啟動]以後，同時按下[程序]與[過程]鍵2秒以上，進入童鎖功能，設定此功能後，除[電源]鍵外所有其它鍵無效，如想解鎖，需同時按下[程序]與[過程]鍵，解除此功能。

水回收程序：洗衣結束後暫不脫水，蜂鳴提示，顯示“EE”，此時可剩起水作其他用途。若想脫水則按下[啟動/暫停]鍵，即可進入脫水程序。如提示後20分鐘無人操作，自動進入脫水程序。

安 裝

洗衣機平放在地面上

- 用戶請勿將包裝底座放在洗衣機下面，否則會損壞洗衣機。
- 安放在平衡，不會打滑的地面上。
- 與牆壁保持100mm以上的距離，便於散熱及降低噪音，不可讓地毯阻塞洗衣機底通風位置。

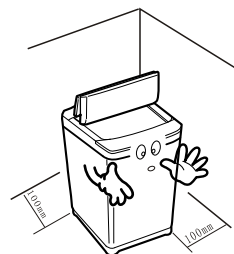
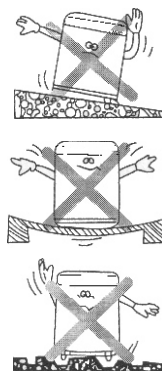
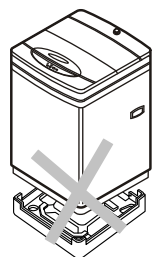

洗衣機水平調整

- 洗衣機前面右側支腳為可調整腳，當洗衣機安放不平時，調整調節腳。

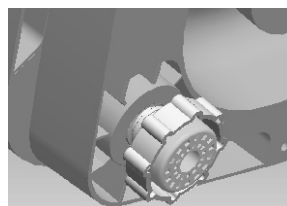





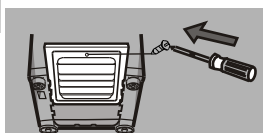
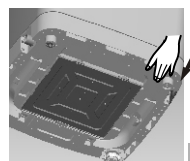

隔音板安裝

- 將隔音板從背後插入到洗衣機底部的安裝槽內。
- 用螺絲批將螺絲擰緊，以固定隔音板。



Washing operation





Delay Start Washing

1. Press the [Power ON/OFF] key.  POWER ON/OFF
2. Press the [program] key.  PROGRAM
According to clothes to be washed, select a washing program [Standard, quick, blanket, gentle, strong, mini wash, child wash, clean tub, air-dry, water recycling]
3. Press the [water level] selector key.  WATER LEVEL
The suitable water level is selected according to cloth nature and clothes weight.
4. Press the [delay start] key.  DELAY START
After it enters into appointed-time preset status, the information window displays appointed default value 1, i.e. 1 hour.
5. Press the [delay start] key.  預約
In appointed preset status, each time you press the [delay start] key, the appointed time will be increased for 1 hour.
6. Close the top cover
Before pressing starts, the top cover must be closed; otherwise, fault E3 will be shown.
7. Press the [start/pause] key.  START/PAUSE
Press the start key, and the machine enters into appointed start status, the appointed time in information window flickers while other indicator is off; when it reaches appointed time, washing operation will be started.

Mini washing

1. Press the [Power ON/OFF] key.  POWER ON/OFF
2. Press the [program] key, select mini wash.  PROGRAM
3. Close the top cover.
4. Press the [start/pause] key.  START/PAUSE
When washing operation is over, the buzzer gives out a prompt, and power will be automatically turned off.

Air-dry (inapplicable to wool washing)

1. Press the [Power ON/OFF] key.  POWER ON/OFF
 2. Press the [program] key, select air-dry.  PROGRAM
 3. Press the [process] key, select time of air-dry:[30min-45min-60min-30min].  PROCESS/SPIN
 4. Close the top cover.
 5. Press the [start/pause] key.  START/PAUSE
When washing operation is over, the buzzer gives out a prompt, and power will be automatically turned off.
- Note: Only Power, Start/Pause and Delay Start function will be able to use while using air-dry function.

Rasonic
樂信牌

Washing operation

Before washing operation, please verify the following items: put the clothes into drum, and detergent into the washing powder box.

Standard washing program - Fuzzy Function

1. Press the [Power ON/OFF] key.



Washing machine auto-enter into standard function. "---" light on. Put cloth.

2. Close the top cover.

3. Press the [start/pause] key.



Washing machine automatically select water level and program mode. Normal Process is "wash→rinse→spin". Washing machine automatically start work.

When washing operation is completed, buzzer gives a prompt, and power supply is automatically turned off.

Selecting washing program

1. Press the [Power ON/OFF] key.



2. Press the [program] key.

According to clothes to be washed, select a washing program [Standard, quick, blanket, gentle, strong, mini wash, child wash, clean tub, air-dry, water recycling]



3. Press the [water level] selector key.



The suitable water level is selected according to cloth nature and clothes weight.

4. Close the top cover.

Before pressing start, the top cover must be closed; otherwise, fault E3 will be shown.

5. Press the [start/pause] key.



Rasonic
樂信牌

安 裝

進水管連接

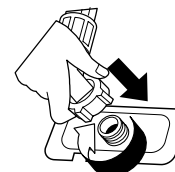

- 1、進水管一端的螺紋口與洗衣機進水閥的螺紋接口擰緊。
- 2、進水管另一端的螺紋接口與水龍頭螺紋口擰緊。
- 3、進水管的兩個螺紋接口都有防水橡膠圈，以防止接合漏水。

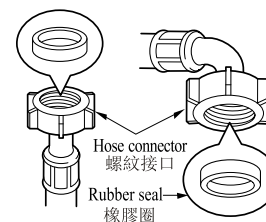
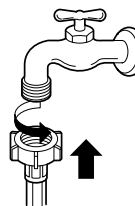

警告：

請勿連接可供應熱水的水龍頭。

注意：

完成連接後，如有漏水情況，請重複以上步驟，重新連接進水管。
請使用隨機附送的新水管，不要使用舊水管。

安 裝

排水管連接

- 將附件中排水管連接到洗衣機側面的排水連接管口上。
- 用彈簧夾固定。
- 洗衣機工作時排水管放下，不能纏繞。
- 排水管口不能高於地面80cm，否則不能正常排水。

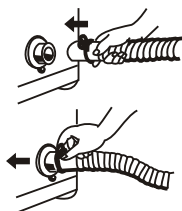

注意

- 洗衣桶在旋轉時，請勿放入衣物或將手放入桶內。
- 大而輕的衣服易浮在水面，請將其按入水裏面再洗滌。
- 脫水過程中，有時會出現衣物偏向一面，引起脫水不平衡，請暫停洗衣機並將衣物均勻放置，重新脫水。
- 衣物不要超出洗衣機最大洗衣量，否則會造成機身異常震動及損壞機件。
- 不要讓洗衣機放在地毯上或讓物件遮蓋散熱位置。
- 避免在無人看管下使用洗衣機。



洗衣前準備

檢查

- | | |
|--------------------------|-------------------|
| ● 檢查衣物是否可以機洗。 | ● 檢查水龍頭是否已打開。 |
| ● 檢查衣物內是否有鑰匙、硬幣、扣針之類的東西。 | ● 檢查排水管是否已安裝到排水渠。 |
| ● 檢查衣物是否要分類洗滌按序進行。 | ● 檢查電源插頭是否插入電源插座。 |

Installation

How to install water inlet hose

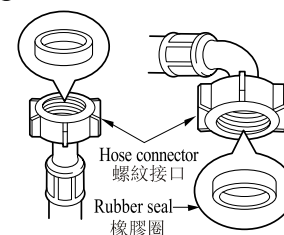
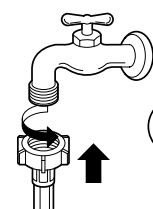
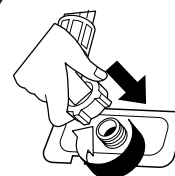

- Two rubber seals are supplied with the water inlet hose in order to prevent leakage.
- Make sure the hose connectors have been completely installed to the machine & tap.
- **CAUTION:** Do not connect to the hot water supply.

Note:

After being connected, if water leakage occurs, just repeat the aforesaid steps to connect water inlet hose again.
Do not use the old water inlet hose. Please install the new water inlet hose to replace the old one.

Special attention

- When washing machine revolving, please do not put in the clothing. Don't put your hand into tub to take the clothing out before the tub stops running.
- Big and light clothing easy to float in the water surface. Please enter it in the water, then starts to wash.
- If the barrel vibrates strongly, must stop running and put clothes evenly again.
- The clothes to be washed should not more than the washing machine capacity.
- Machine must not be placed on the carpet to obstruct the ventilation.
- Avoiding left the washing machine unattended.



Preparations before washing

Check the clothes

- | | |
|--|---|
| ● Check if the clothes can be washed by the washing machine. | ● Check if the water tap is opened. |
| ● Check if there are keys, coins, or pins etc. in the clothes. | ● Check if the drain pipe is inserted into the floor drain. |
| ● Check if the clothes must be classified for washing operation. | ● Check if the power plug has been inserted into the supply socket. |

Installation

Washing machine should be positioned on level and solid ground.

- User must not place the packing foam under the washing machine.
- Positioned on level and solid ground.
- A distance between the machine and wall should be at least 100mm, for easy thermolysis and noise reduction. Machine must not be placed on the carpet to obstruct the ventilating opening.



Horizontal adjustment of washing machine

- The front right foot of the washing machine is the adjustable foot. If the washing machine cannot be positioned horizontally, just adjust the adjustable foot.

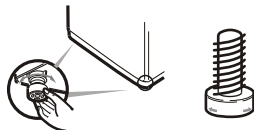

Installation of sound insulation board

- Insert the sound insulation board into the mounting groove at the bottom back of the washing machine.

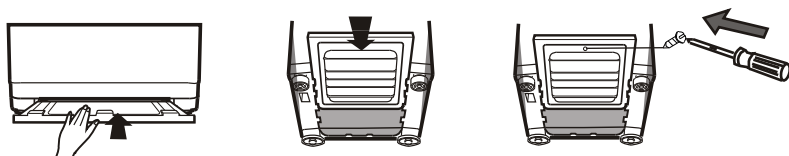

How to install drain pipe

- Connect the drain pipe, to the drain outlet.
 - Fasten it by a spring clamp.
- Please note the drain pipe must not be twisted.
- Orifice of drain pipe must not be placed 80cm higher above the ground, otherwise, normal drainage cannot be proceeded.



Spring clamp
drain pipe

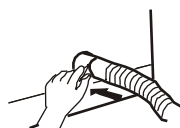
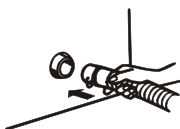

洗滌操作

將衣物放入洗衣桶內，並加入適量洗滌劑

標準洗衣程序 — 快思邏輯

1. 按 [電源開關] 鍵



電源接通後，洗衣機自動設定為 [標準] 洗衣程序，顯示窗顯示 “--”。

2. 關上洗衣機蓋

3. 按 [啟動/暫停] 鍵



啟動後根據衣物重量，自動判斷水位。在標準程序下，按洗滌→漂洗→脫水依序進行，相應的指示燈閃爍。若想暫停，請再按一次 [啟動/暫停] 鍵，暫停期間，可改變洗滌程序。

洗衣結束後，會有聲音提示，電源自動關閉。

自選程序洗衣

1. 按 [電源開關] 鍵



2. 按 [程序] 鍵

根據洗滌衣物選擇洗衣程序 [標準 快速 毛毯 輕柔 強力 迷你洗 兒童洗 潔桶 風乾 水回收]



3. 按 [水位] 選擇鍵

根據衣物質量選擇合適的水位。



4. 關上蓋

按啟動前必須關上洗衣機上蓋，否則出現故障信息 E3。

5. 按 [啟動/暫停] 鍵



洗滌操作

預約洗衣

1. 按 [電源開關] 鍵



POWER ON/OFF

2. 按 [程序] 鍵



PROGRAM

根據洗滌衣物選擇洗衣程序[標準 快速 毛毯 輕柔 強力 迷你洗 兒童洗 潔桶 風乾 水回收]

3. 按 [水位] 選擇鍵



WATER LEVEL

根據衣物重量選擇合適的水位。

4. 按 [預約] 鍵



DELAY START

進入預約時間設定狀態信息窗口顯示預約值1，即1小時。

5. 按 [預約] 鍵



DELAY START

在預約設定狀態下每按[預約]鍵一次，預約時間增加1小時。

6. 關上蓋

預約啟動前必須關上洗衣機上蓋，否則預約啟動後出現故障信息E3。

7. 按 [啟動/暫停] 鍵



START/PAUSE

按啟動鍵後進入預約啟動狀態，信息窗預約時間閃亮，其餘顯示窗熄滅，到設定預約時間後開始洗滌。

迷你洗程序

適合少量，污穢程度輕的衣物洗滌，特別是夏天的衣物。

1. 按 [電源開關] 鍵



POWER ON/OFF

2. 按 [程序] 鍵選擇迷你洗



PROGRAM

3. 關上機蓋

4. 按 [啟動/暫停] 鍵



START/PAUSE

洗衣結束後會有聲音提示，電源自動關閉。

風乾程序

可縮短衣物的晾曬時間（不適用毛料衣物）。

1. 按 [電源開關] 鍵



POWER ON/OFF

2. 按 [程序] 鍵，選擇風乾程序



PROGRAM

3. 按 [過程] 鍵，選擇風乾時間：[30分-45分-60分-30分]



PROCESS/SPIN

4. 關上機蓋

5. 按 [啟動/暫停] 鍵



START/PAUSE

洗衣結束後會有聲音提示，電源自動關閉。

註：選擇風乾程序後，只有電源鍵、啟動/暫停鍵和預約鍵有效。

Control panel

Water level and washing agent

- Select a suitable water level according to cloth nature and weight of clothes; each time you press the water-level selector key, water level varies in the cycling sequence of [10 → 9 → 8 → ... → 1 → 10].

Program select

- Select appropriate washing program according to clothes to be washed and user requirements.

Keystroke times	MAX	WASH	RINSE	SPIN
Default	•	•	•	•
Press once	•	•	•	•
Press the twice	•	•	•	•
Press 3 times	•	•	•	•
Press 4 times	•	•	•	•
Press 5 times	•	•	•	•

Information window

- In normal washing mode, it displays washing remaining time. If trouble occurs in washing procedure, it displays trouble information; in appointed time washing and appointed washing modes, it displays the appointed washing time.
- In self-detecting program, it displays the information of operating status of functional assemblies of the washing machine.

Power ON/OFF

- Press it to turn on power supply, and press once more to turn off power supply.
- If the machine is not operated 1 minute after the washing operation is over, or the machine is not operated in pause status for 5 minutes, power supply of the machine will be automatically turned off

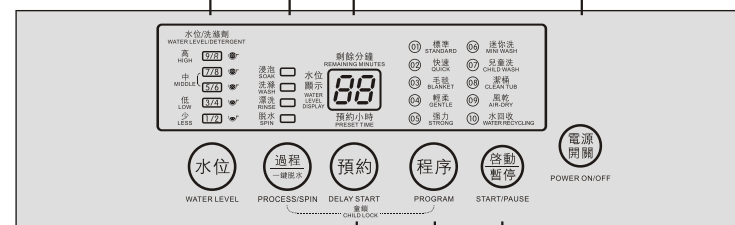

Delay start

- Before the start key is pressed, press the key to enter into appointed-time preset status (after it enters into appointed preset status, default preset value will be displayed for 1 hour).
- After it enters into appointed preset status, each time you press the key, the appointed time will be increased for one hour.

Program selection

- Select appropriate washing program according to clothes to be washed and user requirements.
- Press this key, to convert laundry function:
standard → quick → blanket → gentle → strong → mini wash → child wash → clean tub → air-dry → water recycling.

Start/pause

- After the machine is powered on, press the start / pause key to start washing (after it enters into washing operation, corresponding procedure indicator flickers).
- To pause or change the program of a washing machine in operation, just press the start / pause key.

Child Lock: Press the “Program” key and “Process” key at the same time for 2 seconds, it will enable the child lock function. To unlock, press “Program” key and “Process” key at the same time again.

Water recycle procedure:

When washes finished, procedure of spin will be on hold, buzzer will prompt and “EE” will be display. User can recycle the water in this stage. If wants to continue spinning, please press “Start/ Pause” key, the washer enters the spinning procedure. If no instruction received afterwards for 20 minutes, the washer will enters the spin procedure automatically.

Rasonic
樂信牌

Name of parts

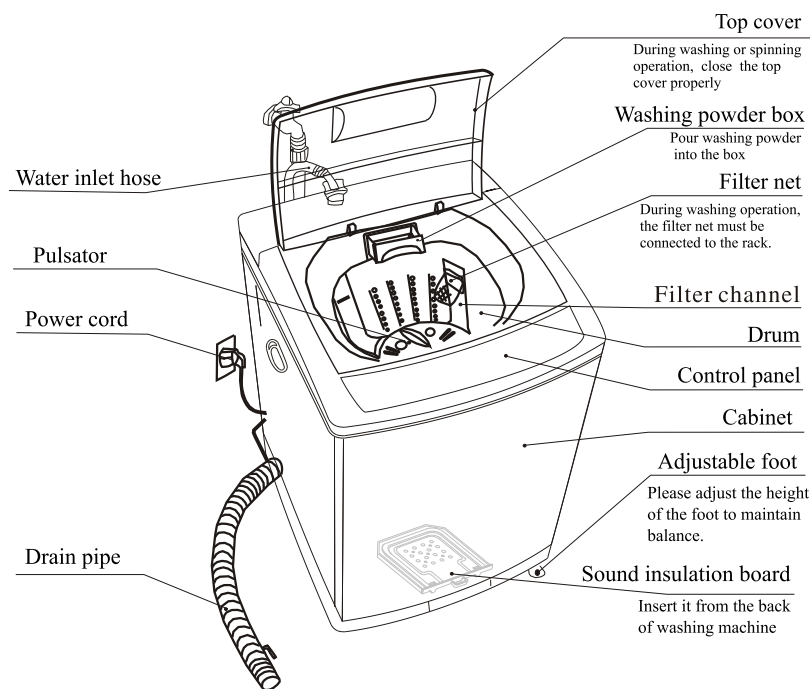

Accessory

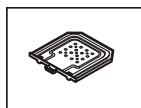

Sound insulation board



Spring clamp /
Drain pipe

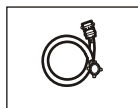

Water inlet hose

Rasonic
樂信牌

洗衣機保養

- 洗衣完成後，請先拔掉電源插頭。

清洗過濾網

- 如圖所示，用手把過濾器卡向上提拉，即可拆下。



- 將過濾網翻轉並清洗。



- 再裝回洗衣機上

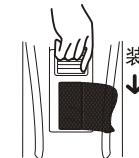

清洗進水閥過濾網

請定期清洗進水閥過濾網：

將過濾網從進水閥內拔出，用刷子清除過濾網上的污垢，用水沖洗後，再放回進水閥內。

注意：

- 取下進水管時，為防止進水管噴水，請按下列步驟進行
 - 關上水龍頭。
 - 打開【電源開關】。
 - 按【啟動/暫停】按鈕。
 - 鬆開並取下洗衣機上的進水管接頭。
 - 按【電源開關】按鈕，以關閉電源。

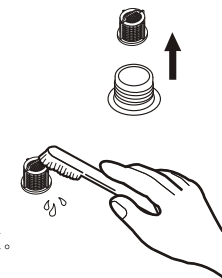

- 進水閥過濾網的污垢會引致不能進水或進水量減少等問題。
- 過濾網清洗後，請裝回進水閥內。

外部清潔

- 不可用水直接沖洗洗衣機。
- 如要清洗，可用乾的軟布擦拭洗衣機。



問題檢測

故障與檢查要點



洗衣機不運轉

- 水龍頭是否打開？
- 電源插座是否插好？
- 電源是否打開？
- 水位是否正常？



無法進水

- 水龍頭是否打開？
- 是否停水？
- 進水管或連接管是否被阻塞？



無法排水

- 排水管是否放下？
 - 排水管是否被阻塞？
- (若在5分鐘內仍無法排水，會發出警報聲音響)



無法脫水

- 衣物是否均勻放在洗衣桶內？
- 洗衣機位置是否平穩？
- 洗衣機上蓋是否關上？

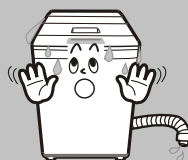

電源不能開
啟或關閉

- 檢查電源是否開關？
- 請聯絡信興電器服務中心有限公司。
(電話：24065666)

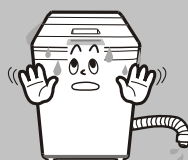

漏水

- 請聯絡信興電器服務中心有限公司。
(電話：24065666)

Precautions

Guide on safety

- Check if the washing machine is securely positioned.

- Washing machine should be positioned on solid level ground.

- During operation do not stretch your hands into the machine; do not allow children to access to the washing machine.

- Put the clothes evenly inside the washing machine, preventing any noises or vibration.



- Do not put anything into the machine with gasoline, kerosene, alcohol or solvent (for fear of fire).

- Do not use hot water (not higher than 50°C) in washing operation, it will damage the plastic parts inside the machine.

- Before washing operation, remove all objects in pockets, especially nails or needles, which may damage the machine or clothes.

- Do not allow any sharp object to put on the top of the machine.

Safety of power cord

- Do unplug the plug by holding the plug body instead of the power cord. Do not place any objects over the power cord or squeeze the power cord.

- To avoid hazard, if power cord is damaged, it must be replaced by Shun Hing Service Centre Ltd. Tel: 24065666

- Do not use broken plug or socket or unplug the power plug by wet hand, to avoid electrical shock.

- In case of town gas/ LPG leakage, to avoid explosion or fire, do not plug or unplug.

- When the washing machine is not in operation, unplug the power plug out of the socket.

Power connection and earthing

- Supply socket must be equipped with reliable earth wire.

- The power socket must be installed with fuse.

Warning:

- Never connect the earth wire to gas pipe, water supply pipe, telephone wire or the earth wire of lightning rod.

- If power cord is damaged, please stop using to avoid electric shock and catching fire.

- If power cord is damaged, please contact Shun Hing Electric Service Centre Ltd Tel:24065666

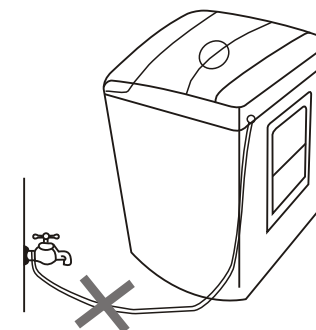

Product features

Auto shutdown

In order to prevent any unpredictable accidents, it will automatically shut down after completed the washing cycle.

24 hours delay washing

Multiple falls dimensional water flow

Multiple circular falls dimensional water flow, improving the cleaning efficiency for large clothing.

Multiple washing flows and 10 water levels setting

The machine can automatically set up optimum washing flow and washing mode according to washing program and water level selected by user.

Air-dry function

Press Air-dry key, using high speed to generate enough wind to cloth. This will shorten the drying process.

Child lock protection

Prevent children from tampering the wash setting once it is locked.

Fuzzy mode

The washing machine will automatically select water level in order to save water & energy consumption.

問題檢測

故障排除

沒有電源

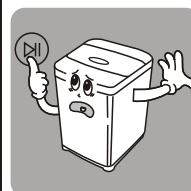

- 檢查電源按鈕是否按下。
- 檢查電源插頭是否插上。
- 檢查是否停電。

脫水時有較大的噪音和振動

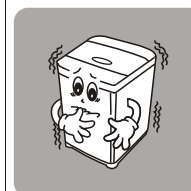

- 檢查衣物是否偏向一面。
- 檢查洗衣機安放是否平穩。
- 檢查隔音板是否裝好。
- 移開洗衣機周圍的雜物。

無法運轉



- 檢查啟動/暫停按鈕是否按下。
- 檢查洗衣桶水量是否合適。
- 檢查水龍頭是否打開。

進水管的連接處漏水

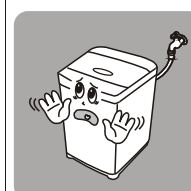

- 與水龍頭連接處是否鬆脫。
- 檢查進水管的橡膠環是否安裝正確。
- 檢查水龍頭是否漏水。

以下情況並非故障

情 況	原 因
在脫水過程中突然轉為漂洗過程	<ul style="list-style-type: none"> * 當衣物不平衡時，為了自動調整衣物的不平衡狀態，會自動轉換為漂洗過程，然後恢復脫水。 * 如上述修正重複進行三次，則出現不平衡故障，此時請按暫停鍵，打開上蓋將衣物放平便可。
在脫水開始時，洗衣桶會時斷時續地旋轉	<ul style="list-style-type: none"> * 脫水開始時，洗衣桶慢慢起動，然後加快，是進行間歇脫水過程，以避免肥皂泡的殘留。
在洗滌過程中進水	<ul style="list-style-type: none"> * 微電腦在洗衣和漂洗過程中會自動檢測水位，水位較低時，會自動加水。
排水動作前波輪輕微、持續地旋轉	<ul style="list-style-type: none"> * 為了防止脫水時衣物偏向一邊產生不平衡現象（脫水時衣物偏向一邊將產生噪音）。
控制面板輕微發熱	<ul style="list-style-type: none"> * 如電源線一直插在插座上，控制面會有輕微發熱，這是正常現象，請放心使用。 * 故不使用時請拔下電源插頭。

故障信息表

故障排除		
信息	故障類型	原 因
E1	進水故障	無水，進水超時，進水閥堵塞。
E2	水位故障	水位低於低水位界限；水位傳感器故障。
E3	機蓋未關上	脫水時蓋未關上；預約啟動前機蓋也要關上。
E4	不平衡故障	脫水過程中出現不平衡現象。
E5	排水故障	排水閥堵塞，排水電機故障，排水超時。
E8	水位故障	水位高於水位界限。
CL	童鎖警報	童鎖設定後機蓋沒有關上。

註：出現故障後開關機蓋或按【啟動/暫停】鍵可解除故障信息。

- 1) 要避免洗衣機操作時震動而產生危險，請勿過量、過少或不平均地放置衣物。
- 2) 請避免在無人看管下使用洗衣機。
- 3) 使用完畢後，請關掉水喉及切斷電源。
- 4) 此電器產品並不是為體質，感覺或智力有障礙人士（包括小孩），或缺乏經驗及知識者使用。除非他們曾經接受負責安全人士的監督或指示。
- 5) 請小心看管小孩，確保他們不會把此洗衣機及其電線當作玩具。
- 6) 不應與其它高耗電量電器共用供電插座，應使用獨立電源插頭。

附錄

程序參考：

程式	浸泡	洗滌	漂洗	脫水	需要時間	水位
標準	15 分	18 分	儲水漂洗 2 次	6 分	約需 53 分	22~55L
快速		6 分	儲水漂洗 1 次	6 分	約需 27 分	22~55L
毛毯		20 分	儲水漂洗 2 次	7 分	約需 70 分	22~55L
輕柔		10 分	儲水漂洗 2 次	5 分	約需 41 分	22~55L
強力		20 分	儲水漂洗 3 次	8 分	約需 71 分	22~55L
迷你洗	5 分	6 分	儲水漂洗 1 次	3 分	約需 17 分	22~55L
兒童洗		20 分	儲水漂洗 2 次	7 分	約需 72 分	20~55L
潔桶		10 分		7 分	約需 23 分	50L
風乾				45 分	約需 45 分	22~55L
水回收		15 分	儲水漂洗 2 次	8 分	約需 50 分	22~55L

以上各程序所需時間只作參考，實際所需時間受以下因素影響：

水位高低而不同

自來水壓、排水條件和衣物等不同

技術參考

型號	RW-H603PC	RW-H703PC
最高洗衣量	6.0公斤	7.0公斤
脫水容量	6.0公斤	7.0公斤
脫水速度	700轉/分鐘	700轉/分鐘
額定功率(洗衣)	380瓦	420瓦
額定功率(乾衣)	380瓦	420瓦
機身尺寸(寬x深x高)	530x530x915毫米	550x550x935毫米
淨重量	29公斤	31公斤
排水位設計	上/下排水	上/下排水

附註：

- 本說明書裡的圖像僅為示意圖。有些示意圖為概念圖並可能與真實產品有所不同。
- 本說明書所有內容經過核對，如有任何印刷錯誤或內容上的誤解，本公司將保留解釋權。
- 本產品若有技術改進，會編進新版說明書中，恕不另行通知；產品外觀及規格以廠方生產資料為準。